

 Paxton

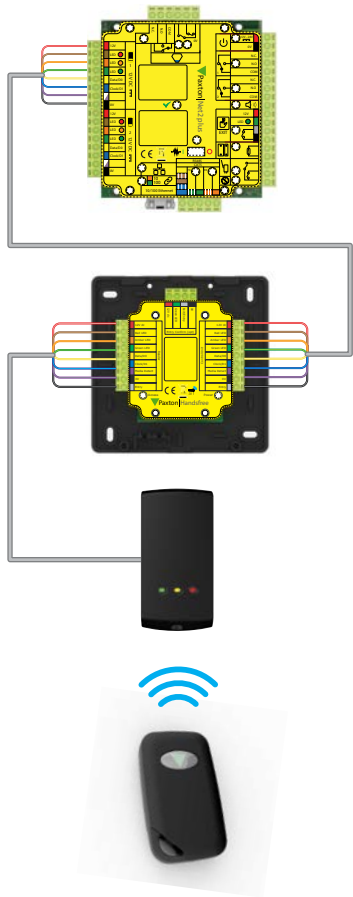

ins-20507





LR ($\leq 5\text{m} / \leq 16\text{ft}$)

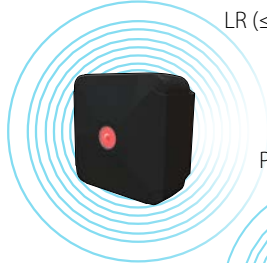

P200 ($\leq 2.5\text{m} / \leq 8\text{ft}$)

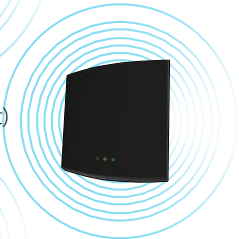

P200E ($\leq 2\text{m} / \leq 6.5\text{ft}$)

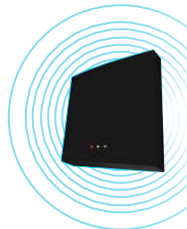

P75 ($\leq 1.5\text{m} / \leq 5\text{ft}$)



P50 ($\leq 1.1\text{m} / \leq 3.6\text{ft}$)



P38 ($\leq 0.85\text{m} / \leq 2.8\text{ft}$)

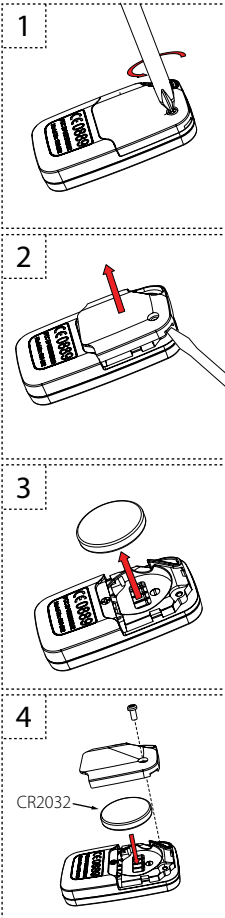

A blue square icon containing a white sine wave with an arrow pointing to the right.

IEEE 802.15.4

A blue square icon containing the text "Net2Air" in white.A large green checkmark.

Net2Air

A blue square icon containing a white thermometer.

0°C - +55°C
32°F - +131°F

A blue square icon containing a white cloud with rain.A large red X mark.



☎ +44 (0)1273 811011
 ✉ support@paxton.co.uk
 💬 paxton.support



☎ +44 (0)1273 811011
 ✉ support@paxton.co.uk
 💬 paxton.support



☎ +1(800) 672-7298
 ✉ supportUS@paxton-access.com
 💬 usapaxton.support



☎ +1(800) 672-7298
 ✉ supportUS@paxton-access.com
 💬 usapaxton.support



☎ +49 (0) 251 2080 6900
 ✉ support@paxton-gmbh.de
 💬 paxton.gmbh.support



☎ +31 (0)76 3333 999
 ✉ support@paxton-benelux.com
 💬 paxton.benelux.support



☎ +31 (0)76 3333 999
 ✉ support@paxton-benelux.com
 💬 paxton.benelux.support



☎ +31 (0)76 3333 999
 ✉ support@paxton-benelux.com
 💬 paxton.benelux.support



☎ +33 (0)157 329356
 ✉ support@paxtonaccess.fr
 💬 paxton.support



☎ +27 (0) 272 14276691
 ✉ support@paxtonaccess.co.za
 💬 paxton.support



☎ +44 (0)1273 811011
 ✉ support@paxton.co.uk
 💬 paxton.support



The declaration of conformity is available on request. Contact details are provided at: <http://paxton.info/596>

These products are not suitable for retail sale. All warranties are invalid if these products are not installed by a competent person.

SAFETY WARNING

RISK OF EXPLOSION IF BATTERY IS REPLACED BY AN INCORRECT TYPE.

DISPOSE OF USED BATTERIES ACCORDING TO THE INSTRUCTIONS.

North America:-

Product compliance and limitations

Wiring methods shall be in accordance with the National Electrical Code (ANSI/NFPA70), local codes, and the authorities having jurisdiction.

FCC Compliance

This device complies with Part 15 of the FCC Rules. Operation is subject to the following two conditions:

(1) this device may not cause harmful interference, and (2) this device must accept any interference received, including interference that may cause undesired operation. Changes or modifications not expressly approved by the party responsible for compliance could void the user's authority to operate the equipment.

We hereby declare that the Net2 Hands Free Keyfob mk2 FCC ID: USE6902M2 is a portable device which has a maximum transmit power of 0.18 mW and is not subject to the routine RF exposure evaluation as per Section 2.1093 of the FCC rules.

Conformité et limitations du produit

Les méthodes de câblage doivent être en accord avec le code national électrique (ANSI/NFPA70), codes locaux et les autorités ayant la juridiction.

Conformité FCC

Ce dispositif est conforme à la section 15 du règlement de la FCC. Le fonctionnement est soumis aux deux conditions suivantes : (1) ce dispositif ne doit pas créer d'interférences nuisibles et (2) ce dispositif doit accepter toute interférence reçue, y compris des interférences qui peuvent causer un fonctionnement non souhaité. Tout changement ou modification non agréé par la partie responsable de la mise en conformité peut entraîner une interdiction d'utilisation de l'équipement.

Nous déclarons par la présente que le Net2 mains libres Keyfob mk2 FCC ID: USE6902M2 est un appareil portable qui a une puissance d'émission maximale de 0,18 mW et ne sont pas soumis à l'évaluation de l'exposition aux RF de routine selon la section 2.1093 de la réglementation FCC.



<http://paxton.info/1606>

 Made in the UK

